



**LICENSING ACT 2003
PREMISES LICENCE**

Cyngor Sir **Ceredigion** County Council



s licence number

PRM 0087 (Issued 14/09/2021)

Premises details

Postal address of premises, or if none, ordnance survey map reference or description

**COOPERS ARMS,
NORTHGATE STREET**

**Post town
ABERYSTWYTH**

**Post code
SY23 2JS**

**Telephone number
01970 624 050**

Where the licence is time limited the dates

LICENCE NOT TIME LIMITED

Licensable activities authorised by the licence

REGULATED ENTERTAINMENT:

PLAYS

FILMS

LIVE MUSIC

RECORDED MUSIC

PERFORMANCES OF DANCE

**ANYTHING OF SIMILAIR DESCRIPTION TO LIVE or RECORDED MUSIC or
PERFORMANCES OF DANCE.**

SALE BY RETAIL OF ALCOHOL

The times the licence authorises the carrying out of licensable activities

REGULATED ENTERTAINMENT:

PLAYS

FILMS

LIVE MUSIC

RECORDED MUSIC

PERFORMANCES OF DANCE

ANYTHING OF SIMILAIR DESCRIPTION TO LIVE or RECORDED MUSIC or PERFORMANCES OF DANCE.

ALL THE ABOVE ACTIVITIES:

MON – SUN: 1200-2400 HRS.

SALE BY RETAIL OF ALCOHOL.

MON-WED: 1100-2400 HRS

THUR-SAT: 1100-0100 HRS

SUN: 1200-2400 HRS.

NON STANDARD TIMINGS (Sale by retail of alcohol only):

BANK HOLIDAYS i.e. SUN and MON: 0100 HRS terminal hour.

CHRISTMAS EVE: 0100 HRS terminal hour.

BOXING DAY: 0100 HRS terminal hour.

TELEVISED INTERNATIONAL SPORTING EVENTS i.e. World Cup, Rugby/Football/Lions Tours/ Cricket/Boxing etc: SUN-WED 0100hrs terminal hour, THU – SAT 0200hrs terminal hour.

NON-STANDARD TIMINGS (All above activities)

NEW YEARS EVE: From commencement of hours on New Years Eve to conclusion of hours New Years Day.

The opening hours of the premises

MON-WED: 0800-0030 HRS

THUR-SAT: 0800-0130 HRS

SUN: 0800-0030 HRS.

NON STANDARD TIMINGS:-

BANK HOLIDAYS, CHRISTMAS EVE & BOXING DAY: Open to 0130 HRS.

NEW YEARS EVE: As detailed at previous section.

TELEVISED INTERNATIONAL SPORTING EVENTS i.e. World Cup, Rugby/Football/Lions Tours/ Cricket/Boxing etc: SUN – WED: 0100hrs, THU – SAT: 0200hrs

Where the licence authorises supplies of alcohol whether these are on and/or off supplies

ON AND OFF SALES

Name, (registered) address, telephone number and email (where relevant) of holder of premises licence

**FELINFOEL BREWERY CO. LTD.
FARMERS ROW,
FELINFOEL,
LLANELLI,
SA14 8LB**

Registered number of holder, for example company number, charity number (where applicable)

Name, address and telephone number of designated premises supervisor where the premises licence authorises the supply of alcohol

SIMON MCQUILLIAM

Personal licence number and issuing authority of personal licence held by designated premises supervisor where the premises licence authorises for the supply of alcohol

DY/50/0755

DUDLEY METROPOLITAN BOROUGH COUNCIL

Annex 1 - MANDATORY CONDITIONS

1 Mandatory conditions where licence authorises supply of alcohol

(1) Where a premises licence authorises the supply of alcohol, the licence must include the following conditions.

(2) The first condition is that no supply of alcohol may be made under the premises licence-

(a) at a time when there is no designated premises supervisor in respect of the premises licence, or

(b) at a time when the designated premises supervisor does not hold a personal licence or his personal licence is suspended.

(3) The second condition is that every supply of alcohol under the premises licence

must be made or authorised by a person who holds a personal licence.

2 Mandatory condition: exhibition of films

(1) Where a premises licence authorises the exhibition of films, the licence must include a condition requiring the admission of children to the exhibition of any film to be restricted in accordance with this section.

(2) Where the film classification body is specified in the licence, unless subsection

(3)(b) applies, admission of children must be restricted in accordance with any recommendation made by that body.

(3) Where-

(a) the film classification body is not specified in the licence, or

(b) the relevant licensing authority has notified the holder of the licence that this subsection applies to the film in question,

admission of children must be restricted in accordance with any recommendation made by that licensing authority.

(4) In this section-

"children" means persons aged under 18; and

"film classification body" means the person or persons designated as the authority under section 4 of the Video Recordings Act 1984 (c.39) (authority to determine suitability of video works for classification).

3 Mandatory condition: door supervision

(1) Where a premises licence includes a condition that at specified times one or more individuals must be at the premises to carry out a security activity, the licence

must include a condition that each such individual must be licensed by the Security

Industry Authority.

- (2) But nothing in subsection (1) requires such a condition to be imposed-
- (a) in respect of premises within paragraph 8(3)(a) of Schedule 2 to the Private Security Industry Act 2001 (c.12) (premises with premises licences authorising plays or films), or
 - (b) in respect of premises in relation to-
 - (i) any occasion mentioned in paragraph 8(3)(b) or (c) of that Schedule (premises being used exclusively by club with club premises certificate, under a temporary event notice authorising plays or films or under a gaming licence), or
 - (ii) any occasion within paragraph 8(3)(d) of that Schedule (occasions prescribed by regulations under that Act).
- (3) For the purposes of this section-
- (a) "security activity" means an activity to which paragraph 2(1)(a) of that Schedule applies, and
 - (b) paragraph 8(5) of that Schedule (interpretation of references to an occasion) applies as it applies in relation to paragraph 8 of that Schedule.

The Licensing Act 2003 (Mandatory Licensing Conditions) Order 2014

With effect from 28th May 2014

1. A relevant person shall ensure that no alcohol is sold or supplied for consumption on or off the premises for a price which is less than the permitted price.
2. For the purposes of the condition set out in paragraph 1-
 - (a) “duty” is to be construed in accordance with the Alcoholic Liquor Duties Act 1979;
 - (b) “permitted price” is the price found by applying the formula –
$$P = D + (D \times V)$$
where –
 - (i) P is the permitted price
 - (ii) D is the rate of duty chargeable in relation to the alcohol as if the duty were charged on the date of the sale or supply of the alcohol, and
 - (iii) V is the rate of value added tax chargeable in relation to the alcohol as if the value added tax were charged on the date of the sale or supply of the alcohol
 - (c) “relevant person” means, in relation to premises in respect of which there is in force a premises licence –
 - (i) The holder of the premises licence,
 - (ii) The designated premises supervisor (if any) in respect of such a licence, or
 - (iii) The personal licence holder who makes or authorises a supply of alcohol under such a licence;
 - (d) “relevant person” means, in relation to premises in respect of which there is in force a club premises certificate, any member or officer of the club present on the premises in a capacity which enables the member or officer to prevent the supply in question; and
 - (e) “valued added tax” means value added tax charged in accordance with the Value Added Tax Act 1994

3. Where the permitted price given by Paragraph (b) of paragraph 2 would (apart from this paragraph) not be a whole number of pennies, the price given by that sub-paragraph shall be taken to be the price actually given by that sub-paragraph rounded up to the nearest penny.
4. (1) Sub-paragraph (2) applies where the permitted price by Paragraph (b) of paragraph 2 on a day ("the first day") would be different from the permitted price on the next day ("the second day") as a result of a change to the rate of duty or value added tax.

(2) The permitted price which would apply on the first day applies to sales or supplies of alcohol which take place before the expiry of the period of 14 days beginning on the second day.

The Licensing Act 2003 (Mandatory Licensing Conditions) (Amendment) Order
2014

The below Mandatory Conditions **replace** the Licensing Act 2003 (Mandatory Licensing Conditions) Order 2010 and comes into effect **on 1st October 2014**

Conditions 1 to 4 refer to all premises that sell or supply alcohol for consumption on the premises. Condition 3 is relevant to Premises that sell for consumption off the premises.

1. (1) The responsible person must ensure that staff on relevant premises do not carry out, arrange or participate in any irresponsible promotions in relation to the premises.

(2) In this paragraph, an irresponsible promotion means any one or more of the following activities, or substantially similar activities, carried on for the purpose of encouraging the sale or supply of alcohol for consumption on the premises—

(a) games or other activities which require or encourage, or are designed to require or encourage, individuals to—

(i) drink a quantity of alcohol within a time limit (other than to drink alcohol sold or supplied on the premises before the cessation of the period in which the responsible person is authorised to sell or supply alcohol), or

(ii) drink as much alcohol as possible (whether within a time limit or otherwise);

(b) provision of unlimited or unspecified quantities of alcohol free or for a fixed or discounted fee to the public or to a group defined by a particular characteristic in a manner which carries a significant risk of undermining a licensing objective;

(c) provision of free or discounted alcohol or any other thing as a prize to encourage or reward the purchase and consumption of alcohol over a period of 24 hours or less in a manner which carries a significant risk of undermining a licensing objective;

(d) selling or supplying alcohol in association with promotional posters or flyers on, or in the vicinity of, the premises which can reasonably be considered to condone, encourage or glamorise anti-social behaviour or to refer to the effects of drunkenness in any favourable manner;

(e) dispensing alcohol directly by one person into the mouth of another (other than where that other person is unable to drink without assistance by reason of disability).

2. The responsible person must ensure that free potable water is provided on request to customers where it is reasonably available.

3. (1) The premises licence holder or club premises certificate holder must ensure that an age verification policy is adopted in respect of the premises in relation to the sale or supply of alcohol.

(2) The designated premises supervisor in relation to the premises licence must ensure that the supply of alcohol at the premises is carried on in accordance with the age verification policy.

(3) The policy must require individuals who appear to the responsible person to be under 18 years of age (or such older age as may be specified in the policy) to produce on request, before being served alcohol, identification bearing their photograph, date of birth and either—

(a) a holographic mark, or

(b) an ultraviolet feature.

4. The responsible person must ensure that—

(a) where any of the following alcoholic drinks is sold or supplied for consumption on the premises (other than alcoholic drinks sold or supplied having been made up in advance ready for sale or supply in a securely closed container) it is available to customers in the following measures—

(i) beer or cider: ½ pint;

(ii) gin, rum, vodka or whisky: 25 ml or 35 ml; and

(iii) still wine in a glass: 125 ml;

(b) these measures are displayed in a menu, price list or other printed material which is available to customers on the premises; and

(c) where a customer does not in relation to a sale of alcohol specify the quantity of alcohol to be sold, the customer is made aware that these measures are available.”

Annex 2 - Conditions consistent with the operating Schedule

Premises Licence is subject to embedded conditions converted under Licensing Act 1964.

Promotion of Licensing Objectives:

a. General - All four licensing objectives:

DPS has been made aware of conditions of Licensing Act 2003.
DPS to instruct staff on Licensing Act 2003 and premises licence conditions.
Training program in place for new staff members.

b. Prevention of Crime and Disorder:

c. Would support pubwatch and any local/national initiatives such as AHRSE and Substance Misuse Policies. Portman Group Code of practice re Alcoholic Drinks observed. Adequate seating provided. No open bottles/glasses to be taken from premises.

d. **Public Safety:** Most fire/safety precautions already in place in respect of current public entertainment: emergency exits/lighting, push bar doors, fire escape, fire doors, fire retardant panelling/drapes/seats, first aid kit, extinguishers. Toughened glasses in use. DPS will comply with fire officer requirements re. maximum occupancy as at present. Fire risk assessment will be carried out by DPS.

e. **Prevention of Public Nuisance:** Noise levels checked outside and by liaison with neighbours as at present. No early morning/late evening deliveries. Empties/refuse removed in morning. No noise pollution from machinery. No cooking odours. No outside drinking area.

f. **Protection of Children from Harm:** Proof of age required:
Validate/Passport/Driving Licence. Children to be allowed on premises only with responsible adult. Under 18's not to play AWP machines, under 16's not to purchase tobacco products. Range of non alcoholic drinks available.

**Annex 3 - Conditions attached after a hearing by the licensing authority/
Mediation meeting**

Annex 4 – Plans



KEY - FIRE SYMBOLS AND ABBREVIATIONS

- ☒ FIRE EXTINGUISHERS WATER TYPE
- ☒ FIRE EXTINGUISHERS FOAM TYPE
- ☒ FIRE EXTINGUISHERS DRY POWDER TYPE
- ☒ FIRE EXTINGUISHERS CARBON DIOXIDE TYPE
- ☒ FIRE EXTINGUISHERS VAPOURISING LIQUID TYPE
- ☒ FIRE ALARMS CALL POINTS
- ☒ AUDIBLE WARNING DEVICES
- ☒ VISUAL WARNING DEVICES
- ☒ AUTOMATIC FIRE DETECTION HEAT
- ☒ AUTOMATIC FIRE DETECTION SMOKE
- ☒ PORTABLE FIRE FIGHTING PANELS
- ☒ EMERGENCY LIGHTING HAND LAMPS
- ☒ EMERGENCY LIGHTING
- ☒ EXIT DIRECTIONAL SIGNS
- ☒ EXIT BOXES
- ☒ FIRE EXIT SIGNS
- ☒ FIRE DIRECTIONAL SIGNS
- ☒ GENERAL FIRE NOTICES
- ☒ STAFF FIRE NOTICES
- ☒ NOTICE IN DOORS
- ☒ FIRE EXIT KEEP CLEAR NOTICES
- ☒ FIRE EXIT KEEP SHUT NOTICES
- ☒ FIRE EXIT PUSH TO OPEN
- ☒ FIRE EXIT KEEP CLEAR NOTICES
- ☒ FIRE EXIT KEEP SHUT NOTICES

ENTRANCE / EXIT / ESCAPE ROUTE

SALC OF ALCOHOL AREA

CONSUPTION OF ALCOHOL & REGULATED ENTERTAINMENT AREAS

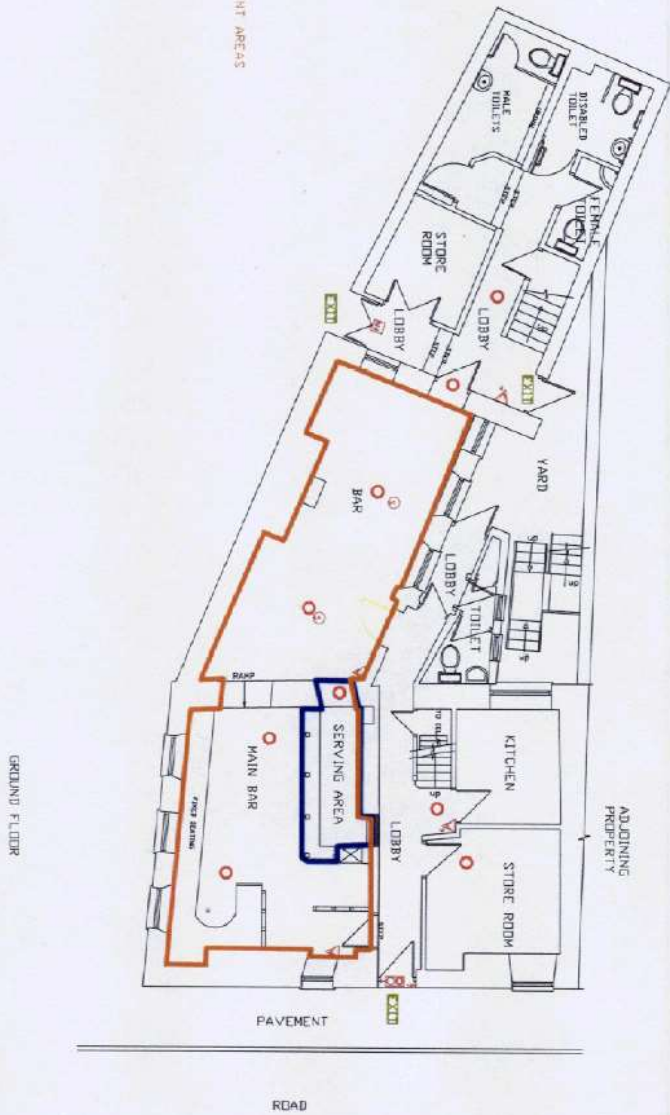

ASTLEY SAMUEL LEEDER
BUILDING SURVEYING & ARCHITECTURAL SERVICES

CLIENT : THE FELLINGDEL BREWERY COMPANY LTD
FELLINGDEL LEANDEL

PROJECT : LAYOUT PLAN OF LICENSED PREMISES

DRAWING TITLE : COOPERS ARMS
NORTHGATE STREET
ABERTSTWTH
GENEEDION

Drawn by : S.J.H.	Checked by :
Scale : 1:100	Date : 02/2005
Drawn by : DAMS/A/C/A	Date :